



**28 Grosvenor Sq., London Road  
(S2 4NS)**



## Key features

Large Bedrooms  
Close to City Centre  
Separate Lounge

Convenient for Sheffield Hallam  
Kitchen & Dining Table  
Burglar Alarm

## Description

Situated in great location close to the City centre, this two-bedroom house benefits from a large Living room, a modern dining kitchen with fridge/freezer, microwave, oven, washing machine and table and chairs. There is a bathroom with bath and overhead shower. Gas-fired central heating, Burglar Alarm, part double glazed. Two bedrooms, each with large beds and fully furnished, plus spare room/study.

## Overview

**Location** London Road  
**Beds** 2 student property  
**Price** £89 Per person per week Approx.  
**Furnishing** Furnished

Call us on  
**01142 660 660**

© Dove Properties and Estates Limited

**Dove Properties**, 430 Ecclesall Road, Sheffield, S11 8PX

**Email** [info@doveproperties.co.uk](mailto:info@doveproperties.co.uk)

**Website** [www.doveproperties.co.uk](http://www.doveproperties.co.uk)

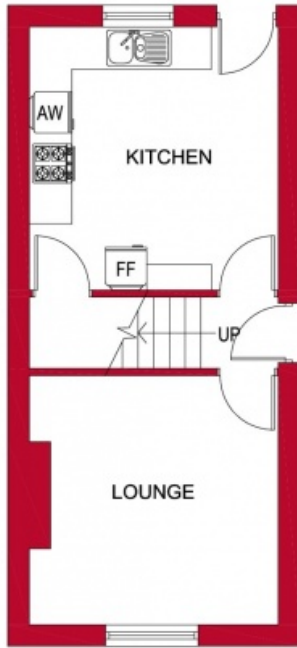

GROUND FLOOR PLAN

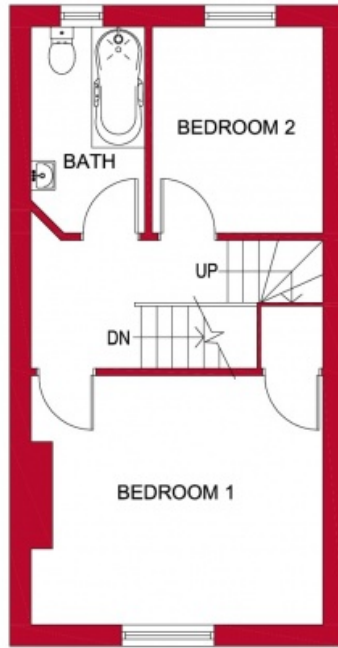

FIRST FLOOR PLAN

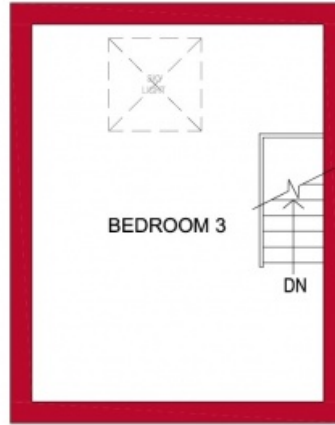

SECOND FLOOR PLAN

LEGEND	
	Sky Light
	Fridge Freezer
	Auto Washing Machine
	Oven & Hob
	Sink
	Toilet
	Bath & Shower

For identification only  
Not to scale

**Disclaimer:**

"While every reasonable effort is made to ensure that information provided is accurate and up to date, no guarantees for the currency or accuracy of information are made. We assume no responsibility for its accuracy, adequacy or completeness of any information and are not responsible for any errors, or omissions, or the results obtained from the use of such information."